

# MEA

Michigan Education Association

Registration deadline July 2.  
Register EARLY—  
Session enrollments are limited.

# Summer Leadership Conference 2009

July 28-30, 2009 • Saginaw Valley State University

*Leading  
with  
Purpose*



Building Full Capacity Locals

## Summer Leadership Conference 2009

July 28–30, 2009 • Saginaw Valley State University

---

### Conference Headquarters: Curtiss Hall

#### 2009 Member Advisory Committee

Iris Salters, MEA President  
Tom Byrum, Co-Chair  
Deborah Lotan, Co-Chair  
Simone Babridge  
Gaylon Barham  
Randy Brady  
Drew Campbell  
Jovita Davis  
Steffany Dean  
Tom DeVault  
Peter Edick  
Deb Irvin  
Rosa Johnson  
Larry Kickham  
William Lusa  
Marcia Mackey  
Maureen Martin  
Katherine Murphy  
U.T. Muse  
Cathy Perini-Korreck  
Heather Pilarz  
Bob Prentice  
Linda Russell  
Pamela Seales  
Jerry Swartz  
Vonnie Taylor  
Stephen Vossler  
Diane Wildfong  
Gilda Wilson

#### 2009 Staff Advisory Committee

Theresa Alderman  
Teri Battaglieri  
Christina Canfield  
Rosemary Carey  
Eduarda Crain  
Cindy Dickstein  
Tom Ferris  
Jonathan Harmon  
Nancy Knight  
Cal Mott  
Linda Myers  
Jeanne O'Callaghan  
Greg Snyder  
Greg Steimel  
Kim Toman  
Damon Wilson

#### Professional Development and Human Rights Department

Joan Mapson, Director  
Frank Ciloski, Consultant, Conference Co-Coordinator  
Mary A. Henson, Consultant, Conference Co-Coordinator  
Bob Harris, Consultant  
Linda Keway, Consultant  
Carolyn Logan, Consultant  
Debra Hahn, Associate Staff  
Monica Ritchie, Associate Staff  
Doreen Trevena, Associate Staff, Conference Assistant  
Judi Weise, Associate Staff

# Table of Contents

---

Message from the President . . . . .	3
Just Between Presidents Breakfast . . . . .	4
Special Pricing . . . . .	5
Conference Happenings. . . . .	7
Tentative Schedule. . . . .	9
Conference Registration Information . . . . .	10
Conference Registration Form . . . . .	11, 12
Local Presidents Designee Selection Form. . . . .	13
SB-CEU Application Form . . . . .	15
ESP Certification Information Page . . . . .	17
Strand Listings . . . . .	18
Session Offerings Grid . . . . .	19
2009 Session Listings . . . . .	20–29
SVSU Housing Information . . . . .	30
SVSU Housing Request Form . . . . .	31
Saginaw Area Hotel/Motel Guide. . . . .	32
Map of the Saginaw Area. . . . .	33
Map of the Campus . . . . .	34

---

The Conference Assistant is Doreen Trevena.  
If you have any questions, Doreen can be contacted at  
800-292-1934, extension 6668 or [dtrevena@mea.org](mailto:dtrevena@mea.org).

**A portion of the cost of this conference is being underwritten by MESSA.**

# Announcing a NEW Learning Opportunity

## Social Justice Institute

### Social Disparities and Student Success

Thursday, July 30 – Friday, July 31, 2009

Saginaw Valley State University

#### Do you know...

- how social class, race or gender affect your school's learning environment?
- how to develop strategies for an inclusive curriculum?
- if human rights issues are visible in the curriculum and student performance measures?
- that social justice issues impact your district making AYP (Adequate Yearly Progress)?

The purpose of the Institute is to provide a conceptual framework for addressing social justice and human rights issues that affect student learning and success.

#### Come learn how to...

- create awareness that social justice and human rights issues are an integral element for student success;
- provide the opportunity for furthering cultural understanding;
- understand the social disparities and challenges that affect learning that impact a district's ability to make AYP; and
- apply strategies that link social justice and human rights to leadership development and professional growth.

Special pricing when you attend both the  
Summer Leadership Conference and Social Justice Institute.

See page 10 or go to [www.mea.org/conference](http://www.mea.org/conference)

# MEA

Michigan Education Association

[www.mea.org/conferences](http://www.mea.org/conferences)

# Message from the President

---

**Register early... it is important to get accurate counts for meals and sessions.**



As leaders, we are faced with guiding our members through both good times and difficult ones. There is no doubt right now that we are presented with challenges, but it is often through obstacles that true opportunity and true leadership arise.

Our Summer Leadership Conference offers the chance to hone your skills and emerge ready to inspire others.

With this year's theme, "Leading with Purpose," you will find a wealth of valuable sessions on communications, finance, membership organization, strategic planning and political action—pertinent any time, but especially important right now.

Our purpose is—and has always been—to build and maintain strong public schools where students get a top-notch education, and we do that through high quality teachers and support staff. Our members work hard to prepare our students for the jobs Michigan needs, but we must also work hard to ensure that education becomes our state and national priority, that those who work in our schools are recognized as professionals, and that our collective voice is heard as the educational landscape changes.

Coming together as a union is also more important than ever. We must take pride in our association and use our combined voice to give input on issues that affect us all. The Summer Leadership Conference will invigorate that pride and give you the resources to build even stronger ties on a local level.

Come prepared to motivate and be motivated!

I look forward to seeing you at Saginaw Valley State University in July.

*Iris R. Salters*

Iris Salters, President

**MEA**

Michigan Education Association

# Just Between Presidents

You are cordially invited to join  
MEA President Iris Salters  
for a special breakfast  
honoring local association presidents

**Date:** Thursday, July 30

**Time:** 7:30 am

**Place:** Saginaw Valley State University

**RSVP:** to accept simply check the box for this event  
on your Summer Leadership Conference registration form  
or  
send an e-mail to [tbattaglieri@mea.org](mailto:tbattaglieri@mea.org)

*Please note that this breakfast is for local association presidents, only (no designees).*

# Special Pricing

---

## Attention Local Presidents

Did you know that you (or your designee) can attend the 2009 Summer Leadership Conference at little or potentially no cost?

The information below is an outline on how to have your registration fee for the Summer Leadership Conference paid and to receive reimbursement for some of the expenses incurred to attend the conference.

### Conference Expenses for Presidents (or designee)

Indicate on the registration form that you are a designee and give the president's name.

Registration fees are prepaid for president/designee for the Summer Leadership Conference (it is NOT necessary to send payment with registration). An expense voucher will be given to you on site; **it must be returned postmarked on or before August 31, 2009.**

Expenses will be reimbursed up to the following:

- 55¢ per mile to and from the conference.
- Lodging of up to \$45 per night, with a detailed receipt, for two (2) nights (Tuesday and Wednesday.) The lodging allowance is based on campus housing costs. **ALL participants are responsible for making their own lodging accommodations.**
- Meals: Up to \$30 per day (Tuesday, Wednesday and Thursday) with receipts per MEA policy.
- All evening meals are on your own and; ARE eligible for reimbursement per MEA policy.
- Bridge fare, if appropriate.

Reimbursement for contractual lost wages for year-round employees requires appropriate documentation on employer letterhead.

It is the president's responsibility to obtain such documentation and it must be sent in with the voucher, **postmarked on or before August 31, 2009.**

**Important Note:** Any Governance Expense Vouchers or request for reimbursement of contractual lost wages postmarked after August 31, 2009 will NOT be processed.

### Attention New Members/Emerging Leaders

A New Member/Emerging Leader is a member in the first six years of employment in the education profession or involvement in the association and who has not previously attended the Summer Leadership Conference. If you are a new member or emerging leader, there is a separate registration fee for you. See page 10.

**Attending the NEW Social Justice Institute?** Members attending both the Summer Leadership Conference and the Social Justice Institute are eligible for a price break on the conference registration fees. See page 10 for further details.

## Personalized Local Affiliate Planning Assistance

**A**re you learning a lot at the conference about turning your local into a Full Capacity Local, starting a PR program or being involved in school board elections? Do you need more time to work with your team or to put your plan together? Then stop by! Staff and leaders will be on hand to assist you in creating a plan that fits your needs.

Although reservations are not required, if you and your team would like to meet with us, please call Heather Traxler at 800-292-1934 or e-mail her at [htraxler@mea.org](mailto:htraxler@mea.org) to make sure we have adequate coverage to meet your needs.

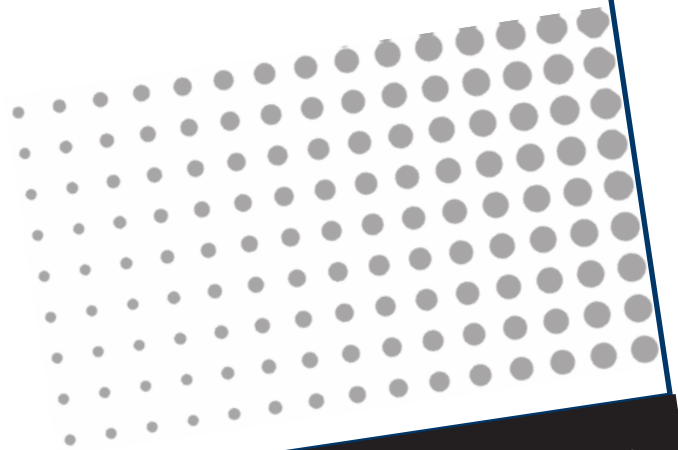

Tuesday 12:45–4:30 p.m. ■ Wednesday 8 a.m.–5:30 p.m. ■ Thursday 8–11:45 a.m.

# Conference Happenings

---

## ■ Internet Access for Conference Participants

On the campus of Saginaw Valley State University, there are kiosks with computers located around Curtiss Hall meeting facility that have internet access. Participants will be able to use these computers, without cost, throughout the conference during breaks, breakfasts and lunches. Because of the number of participants, please limit your use of these computers to 15 minutes.

## ■ Exhibit Area

Remember to check out the exhibits. The exhibit area will be open from 10 a.m. – 4 p.m. Tuesday, 8 a.m. – 4 p.m. Wednesday, and 8 a.m. – 1 p.m. Thursday. Exhibitors include: MEA Financial Services • MESSA • MyMEA.org • ImPACting the Future • and much, much more!

## ■ Meals/Activities

Participants and presenters are welcome to attend all meals and activities at the conference. A completed registration form is required of all attendees. There are separate Activities and Meals Sections on the back of the Registration Form to use.

Participants are able to purchase tickets on site for guests to attend meals and/or activities. Prices will be posted for each of the activities and/or meals at the MEA On-Site Registration Desk.

### **Healthy Steps to Leadership: A Health Awareness Morning – Tuesday, 9:45 a.m. – noon**

Step up your health while you step up your leadership skills.

### **Personalized Local Affiliate Planning Assistance – Tuesday afternoon through Thursday morning**

Staff and leaders will be on hand to assist you in creating a plan that fits your local's needs.

### **ESP Wine & Cheese: A Conference Gathering – Tuesday, 4:30 – 6 p.m.**

The ESP Wine & Cheese: A Conference Gathering will again be cosponsored by the ESP Caucus, MEA Financial Services, MESSA and MEA.

### **'Hustle and Flow' Dance – Tuesday, 8:30 p.m. – midnight**

Want some fun? Want to burn calories and get some exercise? Well, come and get your party on with a professional DJ spinning the tunes. You will get energized and have fun with other Summer Leadership Conference attendees. You will learn the latest dances, do the hustle or line dance. A variety of music will be played – big band swing, top hits, 70s, 80s, 90s, rhythm and blues, etc. So come 'flow' with the Summer Leadership Conference attendees.

### **ImPACting the Future Reception – Wednesday, 5:30 – 7:30 p.m.**

Join MEA Government Affairs and the Local Leader PAC Committee in kicking off the "ImPACting the Future" PAC activities.

## **Saginaw Area**

Information about activities and restaurants in the Saginaw area is available at the Saginaw Valley Convention and Visitors Bureau's Website ([www.visitsaginawcounty.com](http://www.visitsaginawcounty.com)). A list of some hotels/motels in the area is included on page 32 of this announcement.

*Find out how a few small steps can  
make a big difference in your life.*

## ***Healthy Steps to Leadership:***

---

# ***A Health Awareness Morning***

**Tuesday, July 28 from 9:45 a.m.-noon**

**Come visit this MESSA-sponsored pre-conference event at the Summer Leadership Conference**

- ▶ Are you aware of your numbers? Have your blood pressure checked.
- ▶ Get information on how to manage your stress—including exercise!



**MESSA**  
www.messa.org

# Tentative Schedule

The final times may vary slightly from this tentative schedule.

A final schedule will be given to participants on site.

The conference will begin with lunch at 11:30 a.m. on Tuesday, July 28.

## Tuesday, July 28, 2009

- 10 a.m.-6 p.m. . . . . Registration
- 10 a.m.-4 p.m. . . . . Exhibit Area Open
- 9:45 a.m.-noon . . . . . Healthy Steps to Leadership: A Health Awareness Morning
- 11:30 a.m.-12:45 p.m. . . . . Lunch
- 12:45-1 p.m. . . . . Break
- 1-2:30 p.m. . . . . Opening General Session Speaker: Iris Salters, MEA President
- 2:30-2:45 p.m. . . . . Break
- 2:45-4:15 p.m. . . . . Conference Sessions-100 Series
- 4:15-4:30 p.m. . . . . Break
- 4:30-6 p.m. . . . . ESP Wine and Cheese: A Conference Gathering Co-sponsored by ESP Caucus, MESSA, MEA Financial Services and MEA
- 6 p.m. . . . . On Your Own for Dinner (go to [www.visitsaginawcounty.com](http://www.visitsaginawcounty.com) for a list of area restaurants)
- 8:30 p.m. -midnight. . . . . 'Hustle and Flow' Dance with DJ Ryan Rousseau

## Wednesday, July 29, 2009

- 6:45 a.m.-5 p.m. . . . . Registration
- 7:30-8:45 a.m. . . . . Breakfast
- 8 a.m.-4 p.m. . . . . Exhibit Area Open
- 9-10:30 a.m. . . . . Conference Sessions-200 Series
- 10:30-10:45 a.m. . . . . Break
- 10:45 a.m.-12:15 p.m. . . . . Conference Sessions-300 Series
- 12:15-1:45 p.m. . . . . Lunch
- 1:45-2 p.m. . . . . Break
- 2-3:30 p.m. . . . . Conference Sessions-400 Series
- 3:30-3:45 p.m. . . . . Break
- 3:45-5:15 p.m. . . . . Conference Sessions-500 Series
- 5:15-5:30 p.m. . . . . Break
- 5:30-7:30 p.m. . . . . ImPACTing the Future Reception
- 7:30 p.m. . . . . On Your Own for Dinner (go to [www.visitsaginawcounty.com](http://www.visitsaginawcounty.com) for a list of area restaurants)

## Thursday, July 30, 2009

- 6:45 a.m.-noon . . . . . Registration
- 7-8:15 a.m. . . . . Breakfast
- 7-8:15 a.m. . . . . Just Between Presidents Breakfast  
(for Local Association Presidents only – must register)
- 8 a.m.-1 p.m. . . . . Exhibit Area Open
- 8:30-10 a.m. . . . . Conference Sessions – 600 Series
- 10-10:15 a.m. . . . . Break
- 10:15-11:45 a.m. . . . . Conference Sessions – 700 Series

### SB-CEU Credit

Sessions marked with **SB-CEU** will be offered for SB-CEU credit. Participants can receive from .5 to 1.0 SB-CEU based on attendance at approved sessions. To receive the maximum SB-CEUs, a participant must attend an SB-CEU-approved session in each of the seven workshop series and have attendance verified by the presenters at the close of each workshop session.

### ESP Certification

Sessions marked with  will be offered for Michigan ESP Center for Professional Learning (MECPL) credit, in accordance with MEA approved guidelines for the ESP Certificate Program.

# Conference Registration Information

**Registration Deadline: July 2, 2009**  
**Sessions Are Limited... Register Early!**

	Registration Postmarked or Received by July 2		Late or Onsite Postmarked or Received after July 2 or on-site registration	
	SLC	SJI*	SLC	SJI
Local President or designee (see page 5)	\$0	+ \$45 = \$45	\$0	+ \$95 = \$95
MEA Member	150	+ 45 = \$195	215	+ 95 = \$310
New Member/Emerging Leader** (see page 10)	100	+ 45 = \$145	140	+ 95 = \$235
Daily Registration (full day or portion thereof)	100	+ 45 = \$145	140	+ 95 = \$235
Student MEA Members	55	+ 30 = \$85	85	+ 75 = \$160

\* SJI = Social Justice Institute

\*\*A **New Member/Emerging Leader** is a member in the first six years of employment in the education profession or involvement in the association and who has not previously attended the Summer Leadership Conference.

## Registration Guidelines:

- All persons attending all or any part of the conference must register.
- A registration badge/meal ticket will be required for admission to ALL conference sessions and meal functions.
- No registration will be processed without full payment of the registration fee. Payment in full must accompany the registration form. (Local Presidents: See "Conference Expenses for Presidents" on page 5.)
- All cancellations must be in writing. No refunds will be made for cancellations postmarked after July 2, 2009.
- Plan to register early since some sessions have limited enrollment.

Make check or money order payable to the Michigan Education Association and mail to:

Accounting Department  
 Michigan Education Association  
 P.O. Box 2580  
 East Lansing, MI 48826-2580

**Registration deadline is July 2, 2009. Any registration postmarked or received July 3 or after should include the higher registration fee.**

## For Further Information Contact:

800-292-1934 or 517-332-6551

- Mary Henson, Conference Co-Coordinator  
 mhenson@mea.org ext. 6215
- Frank Ciloski, Conference Co-Coordinator  
 fciloski@mea.org ext. 6213
- Doreen Trevena, Conference Assistant  
 dtrevena@mea.org ext. 6668

Professional Development/Human Rights Department  
 Michigan Education Association  
 P.O. Box 2573, East Lansing, MI 48826-2573

# Registrations must be postmarked by July 2, 2009.

**Please complete the ENTIRE registration form.**  
**All information is required to process the registration.**  
**ALL payment information must accompany this registration form** (except local presidents or designee attending Summer Leadership ONLY).

## 2009 Summer Leadership Conference

(PRINT-clearly)

Member's Name: Last \_\_\_\_\_ First \_\_\_\_\_ Initial \_\_\_\_\_ Badge Name: \_\_\_\_\_

Previous/Maiden Name: \_\_\_\_\_ Last 4 digits of Social Security Number: \_\_\_\_\_

Profession:  1) EA Instructional  2) EA Non-Instr.  3) ESP Instr.  4) ESP Non-Instr.  5) Higher Ed  6) Other

**Session Registration**   
**on back.**

School District: \_\_\_\_\_ Home Address: \_\_\_\_\_  
 Street \_\_\_\_\_

Local/Unit: \_\_\_\_\_ City \_\_\_\_\_  
 State \_\_\_\_\_ Zip Code \_\_\_\_\_

School Phone: \_\_\_\_\_ / \_\_\_\_\_ Home Phone: \_\_\_\_\_ / \_\_\_\_\_  
 Summer Phone: \_\_\_\_\_ / \_\_\_\_\_

E-mail: \_\_\_\_\_

Summer E-mail: \_\_\_\_\_

Member Information:  1) MEA member  2) MEA Staff  3) MEA-Retired  4) Student MEA  5) Board

**First time attending Summer Leadership**

Registration Postmarked or Received by  
July 2

Late or On-site Registration Postmarked or Received  
after July 2 or on-site

Type of Registration & Fee (Check One)	SLC	SJI	SLC	SJI	
<input type="checkbox"/> Local President or designee (see page 5)	\$0	+ \$45 = \$45	\$0	+ \$95 = \$95	Note: No need to complete a Social Justice Institute registration form if attending BOTH the Summer Leadership Conference and the Social Justice Institute.
<input type="checkbox"/> MEA Member	150	+ 45 = \$195	215	+ 95 = \$310	
<input type="checkbox"/> New Member/Emerging Leader** (see page 10)	100	+ 45 = \$145	140	+ 95 = \$235	
<input type="checkbox"/> Daily Registration (full day or portion thereof)	100	+ 45 = \$145	140	+ 95 = \$235	
<input type="checkbox"/> Student MEA Members	55	+ 30 = \$85	85	+ 75 = \$160	

I am also attending the Social Justice Institute

Number of registrations included with payment \_\_\_\_\_ of \_\_\_\_\_

Summer Leadership Conf. Amount Enclosed: \$ \_\_\_\_\_

Social Justice Inst. Amount Enclosed: \$ \_\_\_\_\_

TOTAL Payment: \$ \_\_\_\_\_

**Payment Method:**

Check (payable to MEA) Check # \_\_\_\_\_

Received from \_\_\_\_\_

VISA  MasterCard Expiration Date \_\_\_\_\_

Card Number \_\_\_\_\_

Printed Name of Authorized Signer \_\_\_\_\_

Authorized Signature \_\_\_\_\_

**MAIL Form and Payment to:**  
 Accounting Department  
 Michigan Education Association  
 P.O. Box 2580  
 East Lansing, MI 48826-2580

Conference information at:  
**www.mea.org**

OR

**FAX Credit Card Registration to:**  
 517-336-4013

For Accounting Use Only

**Registration Coordinator:**

Doreen Trevena  
 800-292-1934 ext. 6668  
 dtrevena@mea.org

slc

## SLC Session Registration:

Write in the **NUMBER** of the session you would like to attend in each series. (Many sessions continue for two or more time slots. Please sign up for the entire series.)

**You MUST provide 1st, 2nd and 3rd choice for each session.**

SERIES Selection	100 7/28 2:45-4:15 p.m.	200 7/29 9-10:30 a.m.	300 7/29 10:45 a.m.-12:15 p.m.	400 7/29 2-3:30 p.m.	500 7/29 3:45-5:15 p.m.	600 7/30 8:30-10 a.m.	700 7/30 10:15-11:45 a.m.
1st Choice							
2nd Choice							
3rd Choice							

SERIES Selection	100 7/28 2:45-4:15 p.m.	200 7/29 9-10:30 a.m.	300 7/29 10:45 a.m.-12:15 p.m.	400 7/29 2-3:30 p.m.	500 7/29 3:45-5:15 p.m.	600 7/30 8:30-10 a.m.	700 7/30 10:15-11:45 a.m.
1st Choice	101	202	306	409	508	602	713
2nd Choice	103	205	304	404	502	607	702
3rd Choice	109	205	304	404	502	610	708

## MEALS: (Mark yes or no for all meals offered at the conference. **ALL DINNERS ARE ON YOUR OWN.**)

### Tuesday, July 28

Lunch 11:30 a.m.-12:45 p.m.  Yes  No

**Tuesday Lunch:** Grilled chicken, pork loin, red skin potatoes, glazed carrots, mixed greens salad, Caesar salad, carrot cake, beverages

### Wednesday, July 29

Breakfast 7:30-8:45 a.m.  Yes  No

**Wednesday Breakfast:** Pancakes, scrambled eggs, bacon, shredded hash browns, fresh fruit cup, yogurt, individual cereals, oatmeal, bagels, chef's selection of breads, beverages

Lunch 12:15-1:45 p.m.  Yes  No

**Wednesday Lunch:** Beef franks, grilled chicken breast, baked beans, grilled veggies, cookies, beverages

### Thursday, July 30

Breakfast 7-8:15 a.m.  Yes  No

**Thursday Breakfast:** Belgian waffles, quiche, ham, shredded hash browns, fresh fruit cup, yogurt, individual cereals, grits, bagels, chef's selection of breads, beverages

*For breakfast, you may request scrambled Eggbeaters from your wait staff.*

**Special Dietary Needs** (please be specific):

**NOTE:** If you indicate **Vegetarian:** for Tuesday lunch, you must check one: \_\_\_ Spinach lasagna rolls OR \_\_\_ Eggplant parmesan for Wednesday lunch, you will receive a garden burger.

### Just Between Presidents Breakfast

A special breakfast for local association presidents only.

Thursday July 30, 7-8:15 a.m. Banquet Room A

Yes, I will attend.

### Special Needs/Physical Accommodations:

Please note that the conference is held on the campus of Saginaw Valley State University (multiple buildings may be used). If you have any special needs with regard to walking between the buildings, make necessary arrangements prior to your arrival on campus.

## Activities

- **Healthy Steps to Leadership: A Health Awareness Morning (July 28, 9:45 a.m.–noon)**  I will attend  I will NOT attend
- **ESP Wine and Cheese: A Conference Gathering (July 28, 4:30–6 p.m.)**  I will attend  I will NOT attend
- **Hustle & Flow Dance (July 28, 8:30 p.m.–midnight)**  I will attend  I will NOT attend
- **ImpACTing the Future Reception (July 29, 5:30–7:30 p.m.)**  I will attend  I will NOT attend

**PLEASE REVIEW THIS FORM FOR COMPLETENESS PRIOR TO MAILING.**

# Local President's Designee Selection Form

---

## 2009 Summer Leadership Conference

Name of Local: \_\_\_\_\_

Name of President: \_\_\_\_\_  
(PRINT Clearly)

This is to certify that I have selected the following person as my designee for the 2009 Summer Leadership Conference to be held at Saginaw Valley State University, July 28–30.

Name of Designee: \_\_\_\_\_  
(PRINT Clearly)

Designee's Address: \_\_\_\_\_

\_\_\_\_\_  
(City, State, Zip)

Date: \_\_\_\_\_

President's Signature: \_\_\_\_\_

**IMPORTANT NOTE:** Designees will NOT be registered until this form is received. Not submitting this form will result in a delay of the registration and could affect session availability.

**Return this completed form with the designee's registration form to:**

Michigan Education Association  
Doreen Trevena, Conference Assistant  
Professional Development/Human Rights Department  
P.O. Box 2573  
East Lansing, MI 48826-2573

# Certificate of Completion Application

To participate in the SB-CEU program or MECPL ESP Certificate Program for the 2009 Summer Leadership Conference, complete this form and **return prior to the beginning of the conference** to:

Michigan Education Association, Deb Hahn, Professional Development/Human Rights Department, P.O. Box 2573, East Lansing, MI 48826-2573

## SB-CEU Program

**SB-CEU Quick Facts** Individuals who hold the following certificates are eligible to use SB-CEUs for certificate renewal every five (5) years:

The Professional Education Certificate  
The School Psychologist Certificate

The Occupational Education Certificate  
The School Counselor License

The above certificates require renewal every five years. The renewal requirement includes the completion of six semester hours of appropriate coursework through an approved institution, 18 SB-CEUs, or a combination of both.

**Program Title: 2009 Summer Leadership Conference      Completion Date: July 30, 2009**

### Important Notes:

In order to participate in the SB-CEU program for this conference, your application to participate must be **completed and received by the MEA prior to the beginning of the conference**. At this conference, sessions eligible for SB-CEU credit are marked by ~~SB-CEU~~ in the announcement. You will receive an attendance card at the conference. Take this attendance card with you to the sessions. The presenter or facilitator must sign the sheet **before you leave the session**, stating you were in attendance. Actual time "on task" is used to calculate SB-CEU.

You may be denied credit for any of the following reasons:

- You have not documented attendance in all sessions (did not indicate session number or get an authorized signature from a presenter or facilitator on the attendance sheet at the close of each session).
- Your original signed attendance card was not received at the MEA by the established deadline of August 14, 2009.
- You failed to complete the application form and provide your Social Security Number.

## Michigan ESP Center for Professional Learning (MECPL) ESP Certificate Program

The Educational Support Personnel (ESP) Certificate Program is structured to meet the general learning needs of all ESP for any assignment. The ESP Certificate will be issued upon completion of 40 clock hours—at least 5 hours in each of the Core Curriculum Areas of Communication, Legal/Ethical, Behavior Management, and Growth/Development/Psychology for a total of 20 hours. An additional 20 hours of electives are also required. Specific sessions of this conference have been identified by the core curriculum areas and as electives that can be counted for credit toward the ESP Certificate Program. See page 17 of the conference announcement.

### Participant Information (Please Print):

Name: \_\_\_\_\_ Social Security Number: \_\_\_\_\_

Address: \_\_\_\_\_ City: \_\_\_\_\_ State: \_\_\_\_ ZIP: \_\_\_\_\_

Home Phone: \_\_\_\_\_ / \_\_\_\_\_ - \_\_\_\_\_ Work Phone: \_\_\_\_\_ / \_\_\_\_\_ - \_\_\_\_\_

Employing School District: \_\_\_\_\_ E-mail: \_\_\_\_\_

**I wish to participate in the following program** (check only one):  SB-CEU Program  MECPL ESP Certificate Program

**I have read and understand the information on this page and would like to participate in the above program at the 2009 Summer Leadership Conference.**

Participant Signature: \_\_\_\_\_



## MICHIGAN ESP CENTER FOR PROFESSIONAL LEARNING ESP CERTIFICATE PROGRAM

If you would like to receive Michigan ESP Center for Professional Learning (MECPL) credit for attending approved sessions at the 2009 Summer Leadership Conference, here are a few things you will need to do.

**Attendance is critical.** The MECPL program requires that you attend each approved session for the full amount of time allotted (be on time and do not leave the session early).

**Signatures are required.** You will receive a purple MECPL attendance card in your registration packet that you will pick up at the MEA registration desk. Have the presenter sign your card for each individual session. Get these signatures **BEFORE LEAVING** the session.

**It is your responsibility** to return the attendance card (see options below) by August 14, 2009.

**Option 1:** You can drop off the MECPL Attendance Card at the MEA Registration Desk before you leave the conference.

OR

**Option 2:** You can mail the Attendance Card to the Michigan ESP Center for Professional Learning at P.O. Box 2573, East Lansing, MI 48826-2573.

The sessions listed below have been certified as part of the ESP Certificate Program.

### CORE Curriculum

#### Communication

- 106 All the News That's Fit to Print from Content to Design
- 109 Find the SPARK: What Do Newer Members Want & How Do We Get Them Involved?
- 206 Dear Editor: How Do I Get My Voice Heard on Your Opinion Pages?
- 208-308 Effective Leadership 101
- 210-410 Successful Leadership ...It's a Matter of Style
- 314 Toot Your Own Horn – How to Market a Professional Image
- 401 Find the SPARK: What Do Newer Members Want & How Do We Get Them Involved?
- 404-504 Mentoring New Members: A Strategy to Support Involvement
- 408 Making the Case: Communication Strategies on GLBT Issues
- 603-703 Leading with Engaging and Powerful Presentation Skills
- 605-705 Communications – One Style Doesn't Fit All Generations
- 609 Media Training 101
- 707 The Art of the Sound Bite (Media Training 101-Part 2)
- 709 Making the Case: Communication Strategies on GLBT Issues
- 710 Keys 2.0 – Leadership with Data to Back You Up

#### Legal/Ethical

- 209-309 Legal Basics for Local Leaders
- 405-505 Legal Issues for Local Presidents
- 407-507 Special Education Basics: What I Need to Know

### Elective Curriculum

#### Work Environment/School/Organization

- 109 Find the SPARK: What Do Newer Members Want & How Do We Get Them Involved?
- 208-308 Effective Leadership 101
- 210-410 Successful Leadership ...It's a Matter of Style
- 401 Find the SPARK: What Do Newer Members Want & How Do We Get Them Involved?

#### Technology

- 113 Microsoft PowerPoint – Creating an Effective Presentation
- 213-513 Build a Web Site in Just One Day
- 214 Using Web Technologies to Build Full Capacity Locals
- 613-713 Create a School Calendar Using Microsoft PowerPoint
- 714 Using Web Technologies to Build Full Capacity Locals

If you have any questions about the MECPL program or what is required of you, please contact Monica Ritchie at 800-292-1934, extension 6667.

## 2009 Summer Leadership Conference ~ Session Strands

Strand 1	Strand 2	Strand 3	Specialty Sessions
Emerging or New Leader	Novice Leader	Experienced Leader	
is a member who is new to association leadership and is within their first six years of leadership.	is a member who has six but no more than ten years of association leadership who is ready for more skill development.	is a member who has extensive leadership experience and wants to hone their problem solving, decision making, organizing and leadership skills.	is for all members regardless of leadership experience.
Association Representatives - The Face of the Union	All the News That's Fit to Print from Content to Design	Dear Editor: How Do I Get My Voice Heard on Your Opinion Pages?	Build a Web Site in Just One Day
Teacher Certification Update	Duty of Fair Representation I	Duty of Fair Representation II and Legal Representation	Create a School Year Calendar Using Microsoft PowerPoint
Communications - One Style Doesn't Fit All Generations	Just Cause	Mentoring New Members: A Strategy to Support Involvement	Dealing with Disruptive Students in the Classroom
Effective Leadership 101	Leading with Engaging and Powerful Presentation Skills	MESSA Summer School - Benefit Communication Strategies during Crisis Times	MEA Budget Input
Harlan County USA: Our Unity is Our Strength!	Making the Case: Communication Strategies on GLBT Issues	Using Web Technologies to Build Full Capacity Locals	Michigan Graduation Requirements and Curriculum
Legal Basics for Local Leaders	MESSA Summer School - Changing the Insurance Equation: The Value Discussion	What's News?	Microsoft PowerPoint - Creating an Effective Presentation
Media Training 101	Professional Practice Issues and Concerns		Special Education Basics: What I Need to Know as a Leader
Membership Training for Local Membership Chairs and Local Presidents	Recruiting for 3-1(g) Seats		The Mackinac Center and the Education Action Group
MESSA Summer School - An Introduction to Programs and Services	Strengthen Your Local and Get More Members Involved - Starting Today!		Together Everyone Achieves More (TEAM)
Money Matters a Lot!	The Art of the Sound Bite (Media Training 101 - Part 2)		
Passing the Torch - How to Navigate Local Leadership Change	Toot Your Own Horn - How to Market a Professional Image		
Successful Leadership...It's a Matter of Style	Ballot Initiatives		
What's the Role?	Choosing our Candidates - The Screen and Recommendation Process		
	Election 2010		
	Legal Issues for Local Presidents		
Leveraging the Use of Imaging Systems as They Apply to Locals			
Review of Governance Documents			
Planning a PAC Drive			
Tips and Toolkits - What You Need to Know to Prevent Fraud			
Association Fear Factor - Dispelling Myths for New Members			
AYP - Lead It or Be Led By It			
Coffee with a Lobbyist: Politics...the Rest of the Story!			
Elect Your Employer and What to Do after You Elect Them			
Find the Spark: What Do Newer Members Want and How Do We Get Them Involved?			
Health Care in Retirement			
Higher Ed Q & A			
KEYS 2.0 - Leadership with Data to Back You Up			
Legislative Update			
Meet Your Executive Office Team			
Michigan Public School Employees Retirement System (MPSERS)			
Retirement Issues and Legislation			
Union Busting - Right to Work			
What School Employees Should Know About the Social Security Retirement Benefits			

**NOTE:**

Strand listings are only a guide to assist in selections geared toward your level of leadership experience.

# 2009 Summer Leadership Conference

	<b>100</b>	<b>200</b>	<b>300</b>	<b>400</b>	<b>500</b>	<b>600</b>	<b>700</b>	
	<b>Tues. 2:45-4:15 p.m.</b>	<b>Wed. 9:00-10:30 a.m.</b>	<b>Wed. 10:45 a.m.-12:15 p.m.</b>	<b>Wed. 2:00-3:30 p.m.</b>	<b>Wed. 3:45-5:15 p.m.</b>	<b>Thurs. 8:30 - 10:00 a.m.</b>	<b>Thurs. 10:15 - 11:45 a.m.</b>	
<b>1</b>	MESSA Summer School - An Introduction to Programs and Services		What's the Role?	Find the Spark: What Do Newer Members Want and How Do We Get Them Involved?	Harlan County USA: Our Unity is Our Strength!	Strengthen Your Local and Get More Members Involved - Starting Today!		
<b>2</b>	Passing the Torch - How to Navigate Local Leadership Change	<b>OPEN</b>	Meet Your Executive Office Team	Association Representatives - The Face of the Union		Ballot Initiatives	Coffee with a Lobbyist: Politics...the Rest of the Story!	
<b>3</b>	Coffee with a Lobbyist: Politics...the Rest of the Story!		Money Matters A Lot!	Legislative Update	MEA Budget Input	Leading with Engaging and Powerful Presentation Skills		
<b>4</b>	Duty of Fair Representation I	Duty of Fair Representation II and Legal Representation	Choosing our Candidates - The Screen and Recommendation Process	Mentoring New Members: A Strategy to Support Involvement		Tips and Toolkits - What You Need to Know to Prevent Fraud	Harlan County USA: Our Unity is Our Strength!	
<b>5</b>	Planning a PAC Drive	MESSA Summer School - Changing the Insurance Equation: The Value Discussion		Legal Issues for Local Presidents		Communications - One Style Doesn't Fit All Generations		
<b>6</b>	All the News That's Fit to Print from Content to Design	Dear Editor: How Do I Get My Voice Heard on Your Opinion Pages?	Professional Practice Issues and Concerns	Election 2010	MESSA Summer School - Benefit Communication Strategies during Crisis Times	Recruiting for 3-1(g) Seats	Association Fear Factor - Dispelling Myths for New Members	
<b>7</b>	Review of Governance Documents	Dealing with Disruptive Students in the Classroom	Coffee with a Lobbyist: Politics...the Rest of the Story!	Special Education Basics: What I Need to Know as a Leader		AYP - Lead It or Be Led By It	The Art of the Sound Bite (Media Training 101 - Part 2: Time to Get Your Feet Wet)	
<b>8</b>	Teacher Certification Update	Effective Leadership 101		Making the Case: Communication Strategies on GLBT Issues	Just Cause	Association Fear Factor - Dispelling Myths for New Members	Union Busting - Right to Work	
<b>9</b>	Find the Spark: What Do Newer Members Want and How Do We Get Them Involved?	Legal Basics for Local Leaders		Michigan Graduation Requirements and Curriculum		Media Training 101	Making the Case: Communication Strategies on GLBT Issues	
<b>10</b>	The Mackinac Center and the Education Action Group: Who Are These Guys and What Can We do About Them?	Successful Leadership...It's a Matter of Style			Coffee with a Lobbyist: Politics...the Rest of the Story!	<b>OPEN</b>	KEYS 2.0 - Leadership with Data to Back You Up	
<b>11</b>	What School Employees Should Know About the Social Security Retirement Benefits	Retirement Issues and Legislation	Michigan Public School Employees Retirement System (MPSRS)	Together Everyone Achieves More (TEAM)		Health Care in Retirement	Dealing with Disruptive Students in the Classroom	
<b>12</b>	What's News?	Elect Your Employer and What to Do after You Elect Them		Professional Practice Issues and Concerns	Higher Ed Q & A	Leveraging the Use of Imaging Systems as They Apply to Locals	<b>OPEN</b>	
<b>13</b>	Microsoft PowerPoint - Creating an Effective Presentation	Build a Web Site in Just One Day						Create a School Year Calendar Using Microsoft PowerPoint
<b>14</b>		Using Web Technologies to Build Full Capacity Locals	Toot Your Own Horn - How to Market a Professional Image	Membership Training for Local Membership Chairs and Local Presidents			Using Web Technologies to Build Full Capacity Locals	

# 2009 Session Listings

---

**Tuesday, July 28**

**100 Series**

**101 MESSA Summer School - An Introduction to Programs and Services**

**2:45-4:15 p.m.**

MESSA has a proud, rich history. We have been in business since 1960. We are the MEA's health plan. Our mission is to design and administer comprehensive benefit plans and provide outstanding personalized service and value to our members. This session is designed to give you the basic information you will need on our health plans, programs and services. It will also acquaint you with the MESSA Difference, which is so valued by our members.

Recommended: Strand 1 {also suitable for Strand 2}

Presenter: Kirk Bascom

**102 Passing the Torch - How to Navigate Local Leadership Change** **SB-CEU**

**2:45-4:15 p.m.**

Are you a new or newly elected leader picking up the torch of leadership? This session will give you a clearer understanding of the association, beginning with a brief discussion of the organizational structure of MEA (e.g., what is the difference between Coordinating Council vs. Region?). Then learn how to recruit new leaders, bridge the gap between out-going and in-coming leaders, and how to set your goals. You'll also learn how to communicate and include ALL members in your local, regardless of age, years of service, and other factors.

Recommended: Strand 1 {also suitable for Strand 2}

Presenters: Corey Cramb and Jean Robinson

**103 Coffee with a Lobbyist: Politics ... the Rest of the Story!**

**2:45-4:15 p.m.**

This session repeats as Sessions 307, 510 and 702.

Attend this "national award winning" – "limited edition" – Summer Leadership session. Award winning—presented by Government Affairs! Limited edition—attendance limited to 20 members! This is your chance to participate in an interesting session to get background information on current legislation, education issues, future ballot issues, and election politics straight talk only heard by an MEA lobbyist's ears! Imagine no PowerPoint presentation, no handouts, no lecture, no monologue, no exams, and no homework – just good old-fashioned political dialogue. Hear rumors or even create a rumor. This INFORMAL GROUP SESSION will whet the appetite of any MEA political junkie or pundit. JOIN US – experience "real politics" the way we see and hear it at the Michigan Capitol. This session will provide valuable information as you discuss MEA

legislative programs and goals with your members and legislators. Remember, all decisions affecting public education are political decisions.

Recommended: Strands 1, 2 and 3

NOTE: This session limited to 20 participants

Presenters: MEA Lobbyists

**104 Duty of Fair Representation I**

**2:45-4:15 p.m.**

Find out about the duty all local representatives and leaders owe to the members they serve. What should you do when two or more members have conflicting interests? Do all grievances have to be approved for arbitration? These are just a few of the concerns to be addressed in this session.

Recommended: Strand 2 {also suitable for Strand 1}

Presenter: Theresa Alderman

**105 Planning a PAC Drive**

**2:45-4:15 p.m.**

In order to be successful in influencing policymakers at the local, state and national levels, an organization like the MEA must have money. This is called Political Action Committee (PAC) money and it is used mainly to help elect pro-public education candidates to local, state and national offices. This session will help you explain to your members why PAC is so important. We will demonstrate ways for you to ask members for PAC money. You will be provided a step-by-step process of how to build your local MEA-PAC program and how to plan your PAC drive. Most important, we will provide tips on how to make PAC fun and easier.

Recommended: Strands 1 and 2 {also suitable for Specialty Session}

Presenters: Local Leader PAC Committee and Linda Myers

**106 All the News That's Fit to Print from Content to Design**

**SB-CEU** 

**2:45-4:15 p.m.**

Whether it's in print or on the Web, the newsletter is one of the simplest ways to communicate with your colleagues. Bring your ideas for a newsletter and we'll show you how to make those ideas come alive. From planning to design and content, this session will give you a format for a newsletter that works for both print and the Web. (If you've signed up for any of the IT sessions on newsletter design, we recommend you take this session also.)

Recommended: Strand 2 {also suitable for Strands 1 and 3}

Presenter: Rosemary Carey

### **107 Review of Governance Documents**

**2:45-4:15 p.m.**

Are your local constitution and bylaws up-to-date? The MEA Governance Review committee will provide assistance and advice on how to meet standards and requirements for local association governance documents. Members of the committee will explain the review process your local association should complete, as well as provide practical and specific advice to make the process simple and easy. Participants are encouraged to bring their constitutions and bylaws for on-site assistance.

Recommended: Strand 3

Presenter: Rick Long

### **108 Teacher Certification Update**

**2:45-4:15 p.m.**

Leaders, learn critical information that will help you assist your members with their certification questions and more. Learn what teachers need to know about Michigan law and rules regarding obtaining and maintaining a teaching certificate. Participants will learn about the different levels and types of Michigan teaching certificates as well as the teacher's responsibility for maintaining the validity of the certificate. The session will also cover issues around the federal requirement that certain teachers demonstrate competence as a highly qualified teacher of a subject.

Recommended: Strand 1 {also suitable for Strands 2 and 3}

Presenters: Frank Ciloski, Carolyn Logan and Krista Ried

### **109 Find the Spark: What Do Newer Members Want and How Do We Get Them Involved?**

**2:45-4:15 p.m.**

This session repeats as Session 401.

Do you want to get newer members involved? Do you want to learn effective ways to reach out to your newer members? Find out why there is a disconnect among the generations and how to strengthen your local.

Recommended: Strands 1, 2 and 3

Presenters: Melissa Gronzo and Melissa Sortman

### **110 The Mackinac Center and the Education Action Group: Who Are These Guys and What Can We Do About Them?**

**2:45-4:15 p.m.**

In 1978, John Engler and other Republican activists founded the Mackinac Center to promote free market, pro-business policies that would benefit those that fund the center. Since then, the Education Action Group has been cloned to soften up the ground for next year's Right to Work ballot proposal, by opposing the MEA and MESSA wherever it can, through billboards, mass-mailed postcards, newspaper Op Eds and advertisements. Learn all about these organizations: who founded them, who runs them and who funds them, and what you can do.

Recommended: Specialty Session

Presenter: Greg Steimel

### **111 What School Employees Should Know About the Social Security Retirement Benefits**

**2:45-4:15 p.m.**

This session will focus on Social Security Retirement benefits for employees under the Michigan Public Schools Employee Retirement System. The following questions will be answered in detail. How do you qualify for Social Security Retirement benefits? When can you begin to receive your Social Security Retirement benefits? How much Social Security Retirement benefit will you receive? How much will you receive upon your spouse's death? How do your Social Security Retirement benefits and the Equated Options work? What should you know about 403b investments and Social Security Retirement benefits? How do the Medicare benefits and the Michigan Public Schools Employee Retirement System health plan coordinate?

Recommended: Strands 1, 2 and 3

Presenter: Damon Wilson

### **112 What's News?**

**2:45-4:15 p.m.**

Ever wonder why the media covers what they do, the way they do? The answer is based on the principles of news judgment that all reporters are trained in. Understanding these principles of what makes something "news" will make it easier for you to get your story covered.

Recommended: Strand 3 {also suitable for Strand 2}

Presenter: Kerry Birmingham

### **113 Microsoft PowerPoint - Creating an Effective Presentation**

**2:45-4:15 p.m.**

Learn how to use PowerPoint to create effective presentations. After learning a few basic PowerPoint functions and communication techniques, you will be able to use a template to build your own custom presentation. If you have content, pictures, logos or other items you wish to use, bring them with you on a CD or thumb drive. To participate in this session, you should be comfortable with computers, Microsoft software and the Internet.

Recommended: Specialty Session

NOTE: This session is limited to 24 participants.

Presenter: Donette Ramey

**201-301 What's the Role?****9 a.m. -12:15 p.m.**

This session continues as Session 301. Participants must register for the entire series.

Have you ever wondered how the “Leaders” of the association impact your role as a leader? If so, spend some time looking at your role as a new leader and how it connects to your local, coordinating council, state level, and national level. Also, as with most job descriptions, there is more to being the leader than just the title. Learn how to communicate better with your members as well as some simple survival strategies to help get through your first term.

Recommended: Strand 1 {also suitable for Strand 2}

Presenters: Jonathan Harmon, Ervin Pratt and Nancy Valenta

**203-303 Money Matters a Lot!****9 a.m. -12:15 p.m.**

This session continues as Session 303. Participants must register for the entire series.

This session will cover basic record-keeping, financial policies and IRS reporting issues that are important to both new and experienced treasurers. Basic record-keeping will be presented in an automated format and financial policies will focus on ensuring proper internal controls over the association assets. We will identify procedures to keep the treasurer and the local association safe in an ever-changing fiscal and legal environment.

Recommended: Strand 1 {also suitable for Strands 2 and 3}

Presenter: Kim Toman

**204 Duty of Fair Representation II and Legal Representation****9-10:30 a.m.**

Review the basics every leader should know about the Duty of Fair Representation, then delve in deeper. Learn about Article 10 hearings, MEA's internal DFR process, and Legal Representation Appeals.

Recommended: Strand 3 {also suitable for Strand 2}

Presenter: Art Przybylowicz

**205-305 MESSA Summer School - Changing the Insurance Equation: The Value Discussion****9 a.m.-12:15 p.m.**

This session continues as Session 305. Participants must register for the entire series.

Employers always want to focus on the cost of your benefits. What really matters to your bargaining team, your members and the district is the value you receive for the salary dollars spent. This session will help you lead a valuable discussion with your own bargaining team, prioritize health plans using ethical guideposts developed by the American Medical Association, and change the focus at the bargaining table to issues that really matter in a health care plan.

The old adage “you get what you pay for” is particularly true when bargaining a health care plan, but value can be a difficult component to quantify and articulate at the bargaining table. This session is designed to give you the tools you need to engage your members in critically assessing what it is they value in a health plan. Once you look at benefits through this lens, you'll never go back.

Recommended: Strand 2 {also suitable for Strands 1 and 3}

Presenters: Carol Barrett and Grace Romzick

**206 Dear Editor: How Do I Get My Voice Heard on Your Opinion Pages?** **SB-GEU** **9-10:30 a.m.**

In most newspapers, the opinion pages are among the most popular for readers. In this session, you'll learn practical tips to help you influence editorial page coverage of education and association issues. From letters to the editor to in-depth opinion pieces, we'll brainstorm ways for your voice to be heard on the opinion pages of your local newspaper. This session is led by a former newspaper reporter who contributed to editorial coverage at newspapers across Michigan for more than a decade.

Recommended: Strand 3 {also suitable for Strand 2}

Presenter: Kerry Birmingham

**207 Dealing with Disruptive Students in the Classroom** **SB-GEU** **9-10:30 a.m.**

This session repeats as Session 711.

This session is designed to give general guidelines for dealing with disruptive students in the classroom, on your bus, in the hallway, or during school activities. Participants have an opportunity to acquire a basic understanding of what expectations can and should be followed in the school setting.

Recommended: Specialty Session

Presenter: Ric Hogerheide

**208-308 Effective Leadership 101** **SB-GEU** **9 a.m.-12:15 p.m.**

This session continues as Session 308. Participants must register for the entire series.

One of the keys to successful leadership is to apply concepts that have made other leaders strong. This session is designed to help you develop your leadership ability. Adapted from the book, “Leadership 101” by John H. Maxwell, participants will learn what it means to be a leader, the traits for every leader, how to produce a legacy, create a foundation of trust, use self-discipline to improve your character as a leader, follow your vision and bring others with you, and much more. Come to this session to learn what it means to be an effective leader through interactive dialogue, lecture and activities.

Recommended: Strand 1 {also suitable for Strand 2}

Presenters: Theresa Dudley and Mary Henson

## 209-309 Legal Basics for Local Leaders

9 a.m.-12:15 p.m.

This session continues as Session 309. Participants must register for the entire series.

Local leaders and representatives are challenged to know more than ever before about the legal rights of our members. This session will survey several important laws and outline legal rights that every leader should know about, including the duty of fair representation, free speech in the workplace, FMLA, Weingarten rights, and so much more! Become a better representative of your members by understanding their legal rights more clearly.

Recommended: Strand 1 {also suitable for Strand 2}

Presenters: Theresa Alderman, Rick Long and Jeff Murphy

## 210-410 Successful Leadership ... It's a Matter of Style

SB-CEU 

9 a.m.-3:30 p.m.

This session continues as Sessions 310 and 410. Participants must register for the entire series.

All of us have a style or way of doing things. Obviously, all styles are not the same. Do we know what other styles exist and how to work with them in a successful way? This session will focus on the various styles, their strengths and trouble spots, and how you can work successfully with everyone, regardless of their personal style. This session will also identify participants' leadership styles and learn how to adapt them to different situations.

Recommended: Strand 1 {also suitable for Strand 2}

NOTE: This session is limited to 35 participants.

Presenters: Tom Greene and Bob Thomas

## 211 Retirement Issues and Legislation

9-10:30 a.m.

This session will update you on a variety of important topics and changes that have affected the participants of the Michigan Public School Employees Retirement System (MPSERS). An overview of the health insurance benefits and pending legislative issues will be discussed. This informal session will provide participants with an opportunity to have questions answered.

Recommended: Strands 1, 2 and 3

Presenter: Chuck Agerstrand

## 212-312 Elect Your Employer and What to Do after You Elect Them

9 a.m.-12:15 p.m.

This session continues as Session 312. Participants must register for the entire series.

All politics is local. There is no more important elected official in the lives of MEA members than your local school board member. Every year, members have a chance to elect individuals who have a direct impact on local education policy. This session is designed to help

members identify potential candidates, analyze election data and run a successful campaign. Local associations do an excellent job in campaigning and electing a school board candidate; however, once they are elected, we seem to forget them. This session will provide ideas for keeping in constant contact with the person elected and informing him/her about your issues and the impact on the school district. Most often the local superintendent has daily contact with the board, while those who elect them seem to forget who they elected. This session will provide ideas on how to avoid this trap.

Recommended: Strands 1, 2 and 3

Presenters: Local Leaders and Linda Myers

## 213-513 Build a Web Site in Just One Day SB-CEU

9 a.m.-5:15 p.m.

This session continues as Sessions 313 through 513. Participants must register for the entire series.

If you are planning to set up a local Web site—this is the session for you! We will work together to determine what content to include in your site and how to organize it in a way so people can find what they are looking for. YOU will create your new Web site from start to finish. YOU can bring any content you wish to include in your Web site to this session. Simply copy it to a CD or thumb drive and bring it to class! To participate in the session, you should be comfortable with Microsoft Office software, the Internet and computers.

Recommended: Specialty Session

NOTE: This session is limited to 24 participants.

Presenter: Donette Ramey

## 214 Using Web Technologies to Build Full Capacity Locals

9-10:30 a.m.

This session repeats as Session 714.

Please join us to learn and discuss several simple and cost effective strategies for using technology to run your organization more efficiently and effectively. Topics include: effective two-way communication via the Web, creating electronic retrieve-ability, sponsoring your Web site through advertising partners, and much more. Let us show you how to utilize technology to truly do more with less.

Recommended: Strand 3 {also suitable for Strand 2}

NOTE: This session limited to 25 participants.

Presenters: Michael Richter, Kyle Shumaker and Jerry Swartz

**302 Meet Your Executive Office Team****10:45 a.m.-12:15 p.m.**

Come and participate in an open dialogue with MEA's officers and executive director about issues that are on your mind.

Recommended: Strands 1, 2 and 3

Presenters: Iris Salters, Steve Cook, Peggy McLellan and Lu Battaglieri

**304 Choosing Our Candidates - The Screening and Recommendation Process****10:45 a.m.-12:15 p.m.**

MEA's Screening & Recommendation procedure is a grassroots, sophisticated and interesting process. When combined with legislative councils, it can be an exciting and effective activity for politically involved members. Since every "educational decision" in Congress, the state Legislature, or the local school board is a "political decision," join us at this session to truly influence the future of education in Michigan.

Recommended: Strands 2 and 3

Presenters: Government Affairs Staff

**306 Professional Practice Issues and Concerns****SB-CEU****10:45 a.m.-12:15 p.m.**

This session repeats as Session 412.

There may be times when you, as a local leader or advocate, will be called upon to support a member who is in a situation that could lead to the revocation or suspension of their teacher certificate/license. These types of cases can have a devastating impact for the duration of one's teaching career. This session will provide vital information based on Michigan law and State Board policy and procedures. Participants will have the opportunity to engage in open dialogue with Michigan Department of Education staff who handle these cases. Come learn about behaviors that could end one's professional career as an educator and get strategies to advocate for members.

Recommended: Strand 2

Presenter: Stephanie Whiteside

**307 Coffee with a Lobbyist: Politics ... the Rest of the Story!****10:45 a.m.-12:15 p.m.**

This session is a repeat of Session 103. See Session 103 for description. This session repeats as Sessions 510 and 702.

NOTE: This session limited to 20 participants

**311 Michigan Public School Employees Retirement System (MPSERS)****10:45 a.m.-12:15 p.m.**

Is it ever too early to start thinking about retirement? Not anymore! This session will cover the retirement system for public school

employees and provide participants with a thorough understanding of their pension benefits, including a review of the tax-deferred payment plan, service credit purchases, and the health benefit package. Members will be provided with an overview of the MPSERS guidelines and be given the opportunity to ask pension-related questions.

Recommended: Strands 1, 2 and 3

Presenter: Chuck Agerstrand

**314 Toot Your Own Horn - How to Market a Professional Image****SB-CEU** **10:45 a.m.-12:15 p.m.**

You're much more than a school employee—you're a parent or a singer or an animal lover. But that may not be how parents or the community or even the students think of you. Here's a way for people to get to know you—both as a professional and as a person. This is a hands-on session and you'll leave with a ready-made marketing booklet that showcases your strengths, your successes and why you chose to be an education employee.

Recommended: Strand 2 {also suitable for Strand 3}

NOTE: This session is limited to 25 participants.

Presenter: Rosemary Carey

**401 Find the Spark: What Do Newer Members Want and How Do We Get Them Involved?** **2-3:30 p.m.**

This session is a repeat of Session 109. See Session 109 for description.

**402-502 Association Representatives - The Face of the Union****2-5:15 p.m.**

This session continues as Session 502. Participants must register for the entire series.

Everything you need to know to provide EXTRAORDINARY service to members! Association representatives (ARs) are often a member's first (and sometimes only) contact with the union. That being the case, it is critical for a local to have well-trained, knowledgeable, confident ARs who know how to get things done. This high-powered training is guaranteed to give you the knowledge and skills you need to confidently and enthusiastically advocate for members. You'll leave this session filled with ideas and energy plus the tools needed to give your members the top-notch service they deserve.

Recommended: Strand 1 {also suitable for Strand 2}

Presenters: Teri Battaglieri and Arch Lewis

### **403 Legislative Update**

**2-3:30 p.m.**

Budget cuts, MESSA attacks, bargaining rights, charter schools, retirement issues, employee rights, campaign finance, etc., are all topics of legislation affecting higher education, K-12, and pre-K education. Meet with the MEA lobbyists for the current update on such issues.

Recommended: Strands 1, 2 and 3

Presenters: MEA Lobbyists

### **404-504 Mentoring New Members: A Strategy to Support Involvement**

**2-5:15 p.m.**

This session continues as Session 504. Participants must register for the entire series.

As a new member, there is much to learn about the structure, organization, function and value of the association. Knowledge, insight and understanding of these elements are key to new members' determination of how they "fit in" and how/where they might become involved. This, of course, goes beyond the mere promotion of the association and/or retention of members. In this session, participants will explore the leadership practice of mentoring as a means by which new members can learn, become comfortable, and establish themselves as productive, contributing members of the association.

Recommended: Strand 3 {also suitable for Strand 2}

Presenters: Frank Ciloski, Pam DeGryse, Carolyn Logan and Kimberly Simmons

### **405-505 Legal Issues for Local Presidents**

**2-5:15 p.m.**

This session continues as Session 505. Participants must register for the entire series.

This session covers legal issues confronting local presidents, including the duty of fair representation, processing internal appeals, Board of Reference procedures, conducting local elections, agency shop issues, fiduciary duties, and more.

Recommended: Strands 2 and 3

Presenters: Jeff Murphy, Art Przybylowicz and John Walton

### **406 Election 2010**

**2-3:30 p.m.**

In the 2010 election, 14 U.S. Representatives will face re-election, while Congressional District 2 will be an open seat with Peter Hoekstra's decision not to run for re-election. Michigan is facing turnover of statewide elected officials in the November 2 elections. Statewide seats include Governor/Lt. Governor, Secretary of State, Attorney General, and two seats on the Michigan Supreme Court. Beyond the statewide offices, all 38 Senate seats (29 seats are open due to term limits) and 110 House seats are up. Added to this election year will be numerous contests for local school boards,

township and county offices, and judicial positions. The ballot will also carry numerous ballot initiatives that will have an impact on our daily lives. Come and give your input in developing a strategy and plan for MEA's success in electing pro-public education candidates and issues.

Recommended: Strands 2 and 3

Presenter: Linda Myers

### **407-507 Special Education Basics: What I Need to Know as a Leader**

**2-5:15 p.m.**

This session continues as Session 507. Participants must register for the entire series.

This session will include an overview of the special education IEP process, student discipline procedures, complaint procedures including issues presented by violent special education students, and the complaint process. The session is designed to build leaders' capacity in advocating for members on teaching and learning issues as they pertain to special education. This session will incorporate key components of the Individuals with Disabilities Act (IDEIA), a.k.a. IDEA 2004.

Recommended: Specialty Session

Presenters: Cheryl Ervin, Ric Hogerheide, Linda Keway and Mary Lieberman

### **408 Making the Case: Communication Strategies on GLBT Issues**

**2-3:30 a.m.**

This session repeats as Session 709.

This introductory workshop, designed for educators and education leaders, provides an overview of effective messaging and communication strategies on controversial issues, as well as resources and models for talking to constituents about the need to address anti-GLBT bias in schools.

Recommended: Strand 2 {also suitable for Strand 3}

Presenter: Frank Burger

### **409-509 Michigan Graduation Requirements and Curriculum**

**2-5:15 p.m.**

This session continues as Session 509. Participants must register for the entire series.

This session is intended to provide an update on the Michigan High School Graduation requirements and the corresponding Merit Curriculum from Michigan Department of Education staff. The requirements impact the graduates of the Class of 2011 in every Michigan public high school. The participants will learn of any permissible modifications to the requirements and the circumstances under which these may be considered.

Recommended: Specialty Session

Presenter: Sue Cordere

### **411-511 Together Everyone Achieves More (TEAM)**

**2-5:15 p.m.**

This session continues as Session 511. Participants must register for the entire series.

This session will deal with strengthening local MEA-Retired chapters through recruiting, retaining, servicing and communicating with members, as well as sharing ideas and techniques for solving problems unique to MEA-Retired units.

Recommended: Specialty Session

Presenters: Mary Christian, Judy Foster and Dan Rudd

### **412 Professional Practice Issues and Concerns ~~SB-GEU~~**

**2-3:30 p.m.**

This session is a repeat of Session 306. See Session 306 for description.

### **414-514 Membership Training for Local Membership Chairs and Local Presidents**

**2-5:15 p.m.**

This session continues as Session 514. Participants must register for the entire series.

This session will show you how to access and update membership records and percentage dues wages. It will also cover new membership enrollment and changes, billing procedures, dues transmittal policies, PAC, MEA/NEA Retired and much more.

Recommended: Strand 1 {also suitable for Strand 2}

NOTE: This session is limited to 25 participants.

Presenters: Melissa Kale and Ayleen Sims

Recommended: Specialty Session

Presenter: Peggy McLellan

### **506 MESSA Summer School - Benefit Communication Strategies during Crisis Times**

**3:45-5:15 p.m.**

The most important part of crisis planning is to create and then put into practice the components of a plan before an actual crisis takes place. Benefits and health care are under attack. Educational employers have jumped on this bandwagon and you need to be able to guard your members against these attacks. If you are bargaining in the near future, a benefit crisis may be just around the corner. MESSA is the MEA's health plan and this session is designed to help you underscore that message with your members. This session will give you strategies to assist you in promoting and retaining MESSA. You will be given ideas and materials to help you keep the MESSA message alive with your members during bargaining and nonbargaining periods.

Recommended: Strand 3 {also suitable for Strand 2}

Presenter: Cynthia Dickstein

### **508 Just Cause**

**3:45-5:15 p.m.**

Don't confuse "Just Cause" with just because. Too many members equate "just cause" with having a good reason. In fact, just cause is the basic premise upon which advocacy is built. Participants in this session will gain the basics of just cause and use it in simulation exercises. This is more than a sit-and-get session.

Recommended: Strand 2 {also suitable for Strands 1 and 3}

Presenters: Sandra Grier, Ervin Pratt and Nancy Valenta

### **510 Coffee with a Lobbyist: Politics ... the Rest of the Story!**

**3:45-5:15 p.m.**

This session is a repeat of Session 103. See Session 103 for description. This session repeats as Sessions 307 and 702.

NOTE: This session is limited to 20 participants

### **512 Higher Ed Q & A**

**3:45-5:15 p.m.**

This session is designed to cater to the needs of local leaders from higher education units. Come armed with leadership questions and be prepared to ask them and have them answered in a group setting.

Recommended: Strands 1, 2 and 3

Presenter: Rick Long

---

## **Wednesday, July 29**

## **500 Series**

---

### **501 Harlan County USA: Our Unity is Our Strength!**

**3:45-5:15 p.m.**

This session repeats as Session 704.

This award-winning documentary about the West Virginia coal miners' strikes of the 1970's is just as relevant today as it was the year it was produced. Its message of solidarity and unity is timeless. A conversation café goes along with the screening of the film.

Recommended: Strand 1 {also suitable for Strand 2}

Presenter: David Rudzinski

### **503 MEA Budget Input**

**3:45-5:15 p.m.**

As an MEA member your voice counts at all levels of the association. In this session, participants are provided an opportunity to hear about the budget process and to give input that will guide the development of the association's budget.

**601-701 Strengthen Your Local and Get More Members Involved  
- Starting Today!****8:30-11:45 a.m.**

This session continues as Session 701. Participants must register for the entire series.

Come and find out about MEA's initiative to strengthen every local association in the state! Why is Building Full Capacity Locals (BFCL) important? How does it help members? How can your local get involved? This high powered session is designed to answer these questions and give you the information, resources and materials you need to strengthen your local in areas such as: internal and external communications, political action, leadership development, involvement of new members, advocating for members, etc. You will come away from this session energized, confident and filled with ideas! If you want to strengthen your local and motivate your members, this session is a MUST!

Recommended: Strand 2 {also suitable for Strands 1 and 3}

Presenters: Teri Battaglieri and Local Presidents from the Local Presidents Academy

**602 Ballot Initiatives****8:30-10 a.m.**

This session will include a discussion about the initiatives that are proposed and seeking signatures to appear on the November 2, 2010 ballot. These may include Right to Work, something countering Right to Work, Con-Con, Tax Reforms, Shared Health Care for Public Employees, Government Reform, and Smoke Free Environment. What will be MEA's position? How will these issues be included in the campaign plan? What impact will they have on public education?

Recommended: Strands 2 and 3

Presenters: Government Affairs Staff

**603-703 Leading with Engaging and Powerful Presentation Skills****8:30-11:45 a.m.**

This session continues as Session 703. Participants must register for the entire series.

One of the responsibilities of a leader is presenting information. Whether you are speaking to one or 1,000 people, this session will provide you with the necessary skills to be a phenomenal professional presenter. Participants will learn what it takes to make a powerful impression in the first seven seconds of meeting someone, identify the 11 common mistakes, and explore communications and the four traits that make an effective communicator. The 'magic bullet' of communications will be examined as well as a review of the 10 worst fears of presenting. This session will provide an opportunity for participants to examine their 'anxiety' energy and understand how to use that energy effectively. Participants will be able to practice their presentation skills in a safe and engaging environment.

Recommended: Strand 2 {also suitable for Strand 1}

Presenters: Debbie Ballard and Cal Mott

**604 Tips and Toolkits – What You Need to Know to Prevent Fraud****8:30-10 a.m.**

Yes ... fraud can happen in your local. Yes ... there are simple, quick and easy steps you can take to prevent this from happening in your association. This session will provide local leaders with a tool kit of helpful procedures, internal controls, and some do's and don'ts regarding this issue.

Recommended: Strands 1 and 2

Presenter: Peggy McLellan

**605-705 Communications - One Style Doesn't Fit All Generations****8:30-11:45 a.m.**

This session continues as Session 705. Participants must register for the entire series.

Your communication system – whether it's a newsletter, e-mail or a Web site – may not be enough for all of your members, especially your new members. They're the future of your association and you can't afford to leave them out of the loop. Come join us first to learn who our new members are and then to discover how best to hook them up to your communications.

Recommended: Strand 1 {also suitable for Strands 2 and 3}

Presenters: Rosemary Carey and Ed Sarpolus

**606 Recruiting for 3-1(g) Seats****8:30-10 a.m.**

This session will involve some training for any member holding a Representative of Minority 3-1(g) MEA or NEA RA delegate seat. Learn the expectations of holding that seat with respect to issues for minority representation and strategies for MEA and NEA RA delegate accountability and reporting back.

Recommended: Strand 2 {also suitable for Strand 1}

Presenters: Minority Caucus and Minority Concerns Committee Members

**607 AYP - Lead It or Be Led by It** **8:30-10 a.m.**

Every school either makes Adequate Yearly Progress (AYP) or doesn't. No one is excused. And nothing will test your leadership more than AYP. What is the process; what are the sanctions; what can you do? This session will help you understand how and where to insert your leadership in the AYP process and possible outcomes for your school.

Recommended: Strands 1, 2 and 3

Presenter: Bob Harris

### **608 Association Fear Factor - Dispelling Myths for New Members**

**8:30-10 a.m.**

This session repeats as Session 706.

In this session we will work to dispel the myths that new members are often told they should worry about. We will also find ways to engage new members once the myths have been dispelled.

Recommended: Strands 1, 2 and 3

Presenters: Lyn CieChanski, Marcie Felegy and David Kolbicz

### **609 Media Training 101**

**8:30-10 a.m.**

When the media calls, do you know what to do? Or do you mumble “no comment” and run the other way? A seasoned former journalist teaches you how to develop and deliver your messages, how to be a resource and a source, and how to shine on camera – and we don’t mean your nose.

Recommended: Strand 1 {also suitable for Strand 2}

Presenter: Kerry Birmingham

### **611 Health Care in Retirement**

**8:30-10 a.m.**

Bring new retiree leaders up to date on health care when your members transition to Michigan Public Schools Employee Retirement System (MPSERS) benefits.

Recommended: Strands 1, 2 and 3

Presenter: Branko Bojicic

### **612 Leveraging the Use of Imaging Systems as They Apply to Locals**

**8:30-10 a.m.**

Learn how to better record and store your local association’s data and information. Many locals have much information with limited ability to access their information due to institutional memory loss and lack of data retrieval. Lansing EA is pushing into the 21st century storing millions of bits of information that is lost to retrievability in its current form. Learn how to use technology to create better member service in many facets.

Recommended: Strands 1 and 2

Presenters: Suzanne Clark, Mari Martin, Mike Richter, Patti Seidl, Kyle Shumaker and Jerry Swartz

### **613-713 Create a School Year Calendar Using Microsoft PowerPoint**

**8:30-11:45 a.m.**

This session continues as Session 713. Participants must register for the entire series.

Learn how to create a school calendar using Microsoft PowerPoint. You will learn how to select the date range and style for your calendar. You will learn how to add content and pictures to your

calendar and how to print your calendar on paper, add your calendar to your newsletter and e-mail your calendar to others. You will walk away with a ready-to-use calendar! If you have a logo or content you wish to use, simply copy it to a CD or thumb drive and bring to class! To participate in this session, you should be comfortable with Microsoft Office software, the Internet and computers.

Recommended: Specialty Session

NOTE: This session is limited to 24 participants.

Presenter: Donette Ramey

---

## **Thursday, July 30**

## **700 Series**

---

### **702 Coffee with a Lobbyist: Politics ... the Rest of the Story!**

**10:15-11:45 a.m.**

This session is a repeat of Session 103. See Session 103 for description.

NOTE: This session is limited to 20 participants

### **704 Harlan County USA: Our Unity is Our Strength!**

**10:15-11:45 a.m.**

This session is a repeat of Session 501. See Session 501 for description.

### **706 Association Fear Factor - Dispelling Myths for New Members**

**10:15-11:45 a.m.**

This session is a repeat of Session 608. See Session 608 for description.

### **707 The Art of the Sound Bite (Media Training 101 - Part 2: Time to Get Your Feet Wet)**

**10:15-11:45 a.m.**

Conducting a great media interview is an art that requires training and practice. Being a great resource and source for reporters – whether for print, TV, radio or online – is critical to getting good coverage. Learn from a former reporter about how to get your messages into elusive seven-second sound bites, and get hands-on, on-camera practice in talking with the media about your issues. While it’s not required, if you took Media Training 101, this is an opportunity to build on that session.

Recommended: Strand 2 {also suitable for Strand 3}

Presenter: Kerry Birmingham

### **708 Union Busting - Right to Work**

**10:15-11:45 a.m.**

Out-of-state forces are pushing to put a so-called “Right to Work” initiative on Michigan’s 2010 ballot. We must educate our members and the public about this dangerous idea that has nothing to do with anyone’s right to have a job – it has everything to do with requiring everyone to pay their fair share and allowing unions to continue representing and protecting working Americans. Come learn about

the “Right to Work FOR LESS” education effort and what you can do to keep this deceptive scheme from becoming law in Michigan.

Recommended: Strands 1, 2 and 3

Presenter: Linda Myers

### **710 KEYS 2.0 - Leadership with Data to Back You Up**

**SB-CEU** 

**10:15-11:45 a.m.**

NEA's KEYS 2.0 program gives leaders a powerful tool to shape the way schools function. Whether it is in communication, professional development, curriculum, or technology, teachers and support staff need data to make their case for what needs to be done. No more decision-making by individual opinion, KEYS 2.0 gives you a basis for your ideas and your leadership.

Recommended: Strands 1, 2 and 3

Presenter: Bob Harris

### **711 Dealing with Disruptive Students in the Classroom**

**SB-CEU** 

**10:15-11:45 a.m.**

This session is a repeat of Session 207. See Session 207 for description.

### **714 Using Web Technologies to Build Full Capacity Locals**

**10:15-11:45 a.m.**

This session is a repeat of Session 214. See Session 214 for description.

NOTE: This session is limited to 25 participants.

# Saginaw Valley State University Campus Housing Information

MEA Summer Leadership Conference, July 28 – July 30, 2009

- All rooms are non-smoking
- Rooms are air conditioned
- Televisions are not provided; guests may bring a television if desired
- Bring an alarm clock and any other necessary items for your stay. Please remember these are dorm rooms and therefore have limited accommodations.
- Housing assignments are made on a first-come, first-served basis
- **Registration deadline:** Postmarked July 15, 2009

## Housing Option #1- \$84/night

Efficiency: Two-Twin Beds with a shared bathroom and living area.

*Limited number of Option #1 Rooms available.*

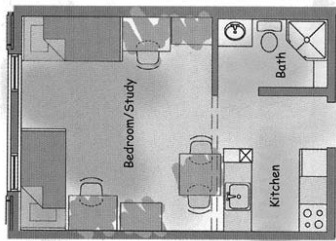

**A roommate is required  
(@ \$42 per person/per night)**

## Housing Option #2 - \$168/night

Apartment: Four-Single Bedrooms (one twin bed in each room) with shared: kitchen, living room, eating area and bathroom.

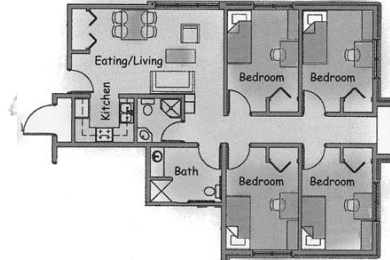

**Participants must have 4 people  
to be booked in these rooms  
(@ \$42 per person/per night)**

## Reservation Policy:

- To make a reservation for University Housing, fill out the form on the next page and send to SVSU at the address listed.
- If housing accommodations are necessary for Monday, July 27<sup>th</sup> or Thursday, July 30<sup>th</sup>, please call (989) 964-2660. *Note: Extended stay cost(s) will NOT be reimbursed per MEA Special (President/Designee) Pricing. See page 5.*
- Payment in full is expected with the Housing Reservation Form.
- No refund will be given if the reservation is canceled on, or after, July 21. If the reservation is canceled prior to July 21, the amount paid, minus a \$25.00 service fee, will be processed after August 3.

## Check-In/Check-Out Information:

Check-In Location: Room registration at the Curtiss Hall Information Desk

Check-In Dates & Times: Tuesday, July 28, 10:00 a.m. – 6:00 p.m.  
Wednesday, July 29, 12:00 p.m. – 3:00 p.m.

Check-Out Time: Check out by noon. Keys may be dropped at the desk located on the 1<sup>st</sup> floor Living Center North OR at the Curtiss Hall Information Desk.

MEA Summer Leadership Conference, July 28 – July 30, 2009

**Mail completed forms to:**  
University Conference & Events Center  
Attn.: MEA Housing  
Curtiss Hall, C-201  
7400 Bay Road, University Center, MI 48710

**Call UCEC for Questions: 989-964-2660**

**Information for Primary Contact Person (please print clearly):**

Name: \_\_\_\_\_

Email Address (required): \_\_\_\_\_

Mailing Address (summer): \_\_\_\_\_

Phone Number (summer): \_\_\_\_\_

**Housing Request Deadline Postmarked: Wednesday, July 15, 2009**

**Please submit only ONE form per room with all guests' names (if known).**

**Indicate room reservation dates:**     Tuesday, July 28, 2009     Wednesday, July 29, 2009

**Indicate your housing preference (all rooms are non-smoking):**

\_\_\_\_\_ **Option 1 - \$84 per night: Living Center Efficiency: Two-Twin Beds**

**Limited number rooms are available. A roommate is required. If you wish for a roommate to be assigned, please indicate it on this form.**

Names of Individuals sharing this room (@ \$42 per person/per night):

(1) \_\_\_\_\_ (2) \_\_\_\_\_

\_\_\_\_\_ **Option 2 - \$168 per night: Living Center Apartment: Four Single Bedrooms**

One twin bed in each room with shared areas: kitchen, living room, eating area and bathroom

**Limited number rooms are available. Roommates (must have 4 total) are required. If you wish for other roommates to be assigned, please indicate it on this form.**

Names of Individuals sharing this room (@ \$42 per person/per night):

(1) \_\_\_\_\_ (2) \_\_\_\_\_

(3) \_\_\_\_\_ (4) \_\_\_\_\_

**Payment Information: (Please make checks payable to SVSU. Full payment is due at the time of request.)**

Payment Amount: \$ \_\_\_\_\_

Cash: \_\_\_\_\_ Check #: \_\_\_\_\_ Credit Card (Visa, MC, or Discover): \_\_\_\_\_

Expiration Date: \_\_\_\_\_ V-Code: \_\_\_\_\_ Card Number: \_\_\_\_\_

Print Name of Authorized Signer: \_\_\_\_\_

Authorized Signature: \_\_\_\_\_

# Hotel/Motel Guide of Members of the Saginaw Valley Visitors Bureau

This list is being supplied for your information only. Facilities have not been visited by conference staff.  
**ALL participants are responsible for making their own hotel accommodations.**

Hotel Name	Address	Phone	# of Units
America's Best Value Inn	9087 E. Birch Run Rd., Birch Run	(989) 624-9395	150
Bavarian Inn Lodge	One Covered Bridge Lane, Frankenmuth	(989) 652-7200	360
Bay Valley Hotel and Resort	2470 Old Bridge Road, Bay City	(989) 686-3540	
Baymont Inn & Suites	6460 Dixie Hwy., Bridgeport	(989) 777-3000	100
Best Value Inn	6300 Bay Rd., Saginaw	(989) 790-9454	29
Best Western–Saginaw/Frankenmuth Area	1408 S. Outer Dr. @ I-75 & Holland, Saginaw	(989) 755-0461	158
Comfort Inn–Birch Run	11911 Dixie Hwy., Birch Run	(989) 624-7777	99
Comfort Suites	5180 Fashion Square Blvd., Saginaw	(989) 797-8000	66
Country Inn & Suites	12112 S. Beyer Rd., Birch Run	(989) 624-8000	71
Drury Inn & Suites	260 S. Main St., Frankenmuth	(989) 652-2800	78
Fairfield Inn–Frankenmuth	430 S. Main St., Frankenmuth	(989) 652-5000	63
Fairfield Inn–Saginaw	5200 Fashion Square Blvd., Saginaw	(989) 797-6100	76
Four Points Hotel by Sheraton	4960 Towne Centre/I-675, Saginaw	(989) 790-5050	156
Frankenmuth Motel	1218 S. Weiss St., Frankenmuth	(989) 652-6171	54
Hampton Inn–Birch Run	12130 Tiffany Blvd., Birch Run	(989) 624-2500	89
Hampton Inn–Hilton Hotels	2222 Tittabawassee Rd./I-675, Saginaw	(989) 792-7666	120
Holiday Inn Express–Bay City	3959 Traxler Ct., Bay City	(989) 667-3800	77
Holiday Inn Express–Birch Run	12150 Dixie Hwy., Birch Run	(989) 624-9300	95
Holiday Inn Express–Hotels & Suites	2501 Tittabawassee Rd., Saginaw	(989) 792-7500	98
Knights Inn North	2225 Tittabawassee Rd./I-675, Saginaw	(989) 791-1411	101
Miller's Motel	4853 Dixie Hwy., Saginaw	(989) 777-5250	16
Motel 6	966 S. Outer Drive, Saginaw	(989) 754-8414	
Ramada Inn & Suites	3325 Davenport Ave., Saginaw	(989) 793-7900	95
Springhill Suites by Marriott–Frankenmuth	530 S. Main, Frankenmuth	(989) 652-7500	66
Springhill Suites by Marriott–Saginaw	5270 Fashion Square Blvd., Saginaw	(989) 792-2800	
Super 7	1415 S. Outer Dr. @ I-75 & Holland, Saginaw	(989) 754-9200	101
Super 8 Motel–Birch Run	9235 Birch Run Rd., Birch Run	(989) 624-4440	110
Super 8 Motel–Saginaw	4848 Towne Centre/I-675, Saginaw	(989) 791-3003	58
Zehnder's Splash Village Hotel-Waterpark	1365 S. Main (M-83), Frankenmuth	(989) 652-0470	137

**Saginaw will be the site of another conference  
during our stay. Reserve your room early!**

NOTE: For more information on these hotels/motels, including information about pools and pets, or activities available in and around the city, visit the Saginaw County Web site:  
[www.visitsaginawcounty.com](http://www.visitsaginawcounty.com).

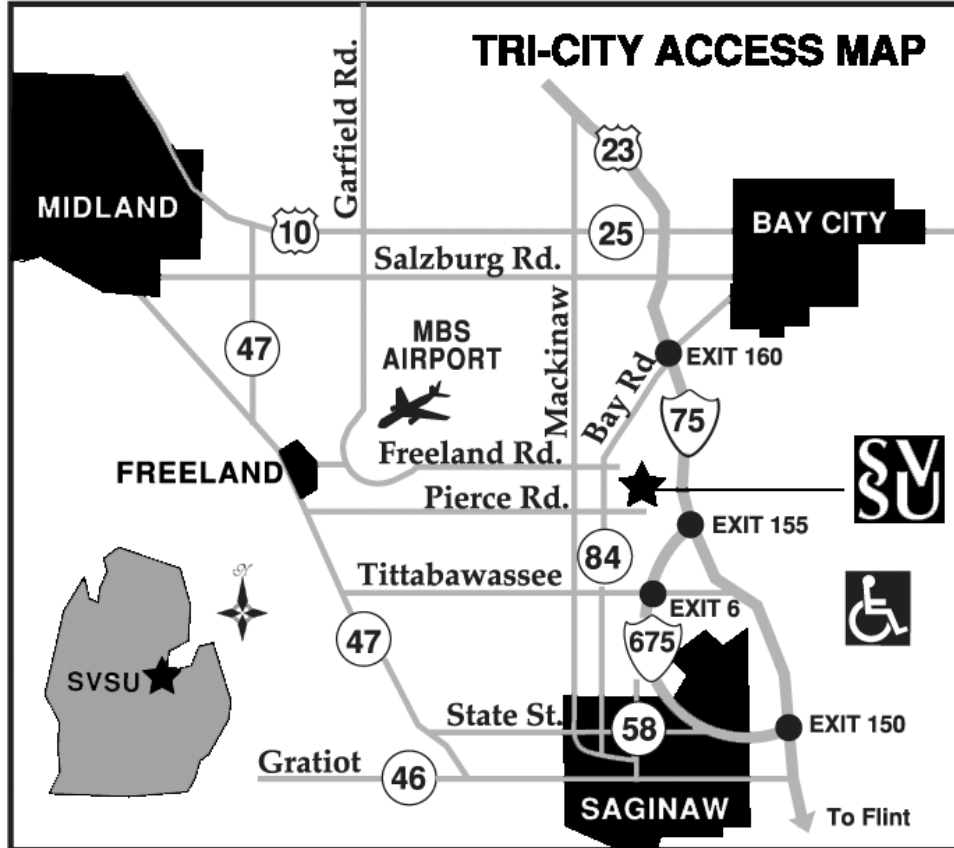

## Directions to SVSU:

### From I-75:

Exit 160 (Bay Road – M-84), travel south on Bay for 4.5 miles.  
SVSU is on the east side.

### From MBS Airport:

Travel along Freeland Road (5 miles),  
turn right, travel south on Bay Road – M-84 (.5 miles)  
SVSU entrance is on the east side.

**Saginaw Valley State University**  
7400 Bay Road  
University Center, MI 48710-0001

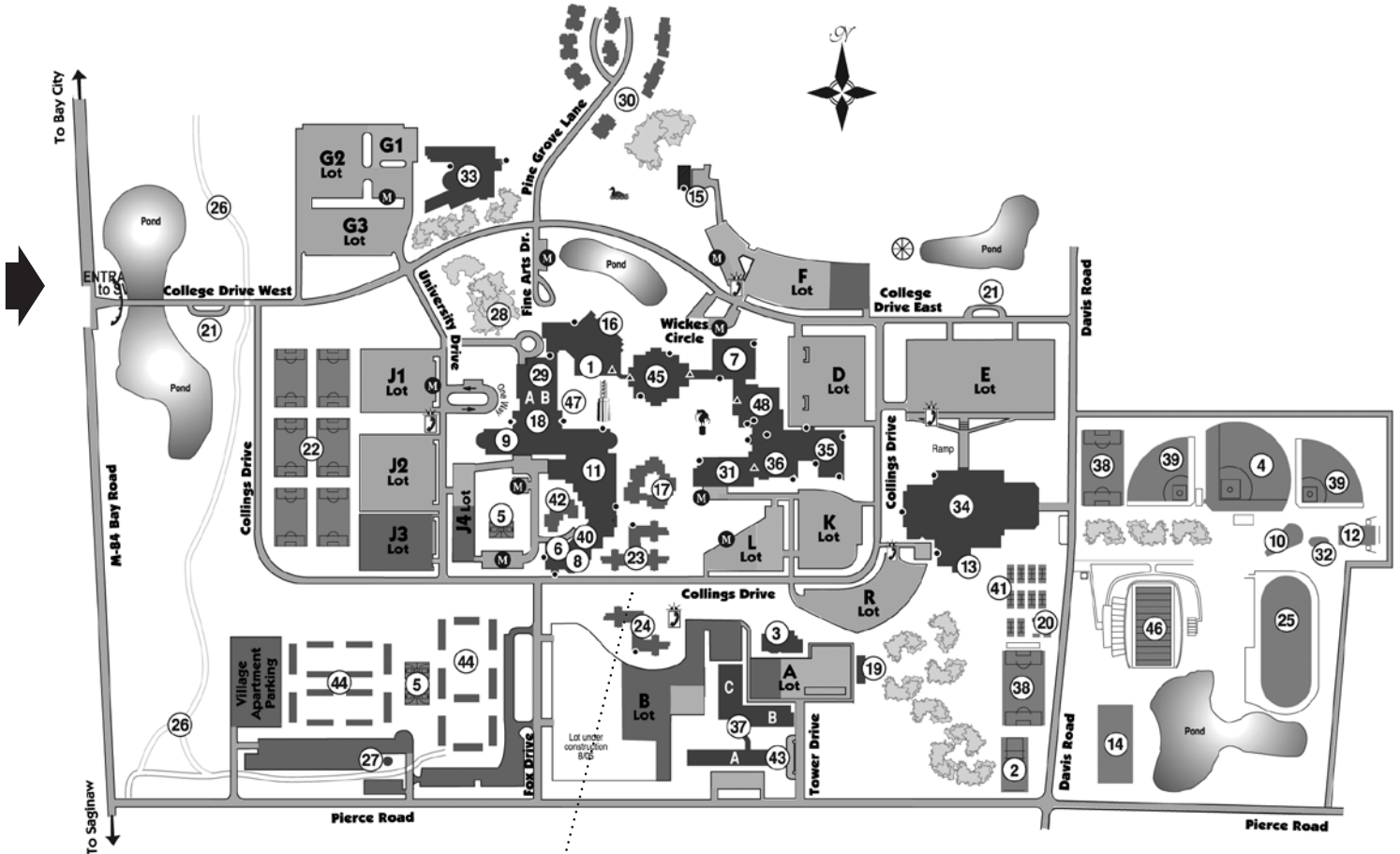

- |                                 |   |   |  |
|---------------------------------|---|---|--|
| 1. Arbury Fine Arts Center      | 16. Marshall M. Fredericks Sculpture Museum             | 29. Performing Arts Center<br>A. Performing Arts Theatre<br>B. Rhea Miller Recital Hall | 38. Soccer Fields                                    |
| 2. Archery Range                | 17. Great Lakes Residence Halls (First Year Suites A-E) | 30. Pine Grove Apartments   | 39. Softball Field                                   |
| 3. Auditorium                   | 18. Groening Commons                                    | 31. Pioneer Hall of Engineering & Technology  | 40. Student Center                                   |
| 4. Baseball Field               | 19. Grounds Building                                    | 32. Putting Green   | 41. Tennis Courts                                    |
| 5. Basketball Intramural Courts | 20. Horseshoe Pits                                      | 33. Regional Education Center (Regional Math/Science Center)                            | 42. Tranquil Residence Halls (First Year Suites F&G) |
| 6. Bookstore                    | 21. Information Kiosk                                   | 34. Ryder Center for Health & Physical Education  | 43. University Police/ Parking Services              |
| 7. Brown Hall                   | 22. Intramural Fields                                   | 35. Dow Doan Science Building East  | 44. University Village                               |
| 8. Convenience Store            | 23. Living Center North                                 | 36. Dow Doan Science Building West  | 45. Wickes Hall (Admissions & Financial Aid)         |
| 9. Curtiss Hall                 | 24. Living Center South                                 | 37. South Campus (Complex Buildings A,B&C)  | 46. Wickes Memorial Stadium                          |
| 10. Discus Throw                | 25. Morley Field  |   | 47. Zahnaw Amphitheatre                              |
| 11. Doan Center                 | 26. Non-Motorized Pathway                               |   | 48. Zahnaw Library                                   |
| 12. Driving Range               | 27. Observatory   |   |  |
| 13. Fitness Center              | 28. Owsley Grove  |   |  |
| 14. Football Practice Field     |   |   |  |
| 15. Founders Hall               |   |   |  |

# MEA

---

## Michigan Education Association

P.O. Box 2573, East Lansing, MI 48826-2573

517-332-6551 or 800-292-1934

[www.mea.org](http://www.mea.org)

Iris K. Salters, President • Steven B. Cook, Vice President • Peggy McLellan, Secretary-Treasurer • Lu Battaglieri, Executive Director

*The mission of the MEA is to ensure that the education of our students and  
the working environments of our members are of the highest quality.*

